



Ormond House, Westminster  
London SW1P

GARTONJONES.COM



# Ormond House, Westminster London, SW1P

## £400 Per Week

A well proportioned and recently refurbished one bedroom apartment on the 1st floor of this purpose built development situated in a quiet residential road. The apartment is offered partly furnished (no bed or sofa but can be negotiated) and offers a good size reception, modern integrated kitchen, double bedroom with direct access to a private balcony and a contemporary bathroom. Further benefits include ample storage, secure underground parking and a porter. Medway Street is extremely convenient for access to many of the renowned local landmarks which include the Houses of Parliament, Westminster Abbey, Tate Britain Gallery and the River Thames. The local transport links of Victoria Station is nearby providing mainline UK services including the Gatwick Express as well as the underground services of Victoria, Pimlico, St James Park and Westminster. The area has an abundance of amenities such as Sainsbury's, Waitrose, Marks & Spencer's, House of Fraser and a Curzon Cinema plus following on from the extensive regeneration of Victoria street a selection of many new restaurants to compliment existing ones such as The Vincent Rooms, The Cinnamon Club, Quirinale and many more.

- 514 sq.ft (48sq.m)
- One Bedroom Apartment
- 1st Floor (Lift)
- Bright Reception Room
- Smart Integrated Kitchen
- Modern Bathroom
- Private Balcony & Day Porter
- Secure Underground Parking
- Close to Local Amenities Including Shops, Restaurants & Transport Links
- Walking Distance to

## GARTON JONES.COM

49 Marsham Street Lettings:

London

SW1P 3DP

+44 (0) 20 7340 0480

[westminster@gartonjones.com](mailto:westminster@gartonjones.com)

[www.gartonjones.com](http://www.gartonjones.com)

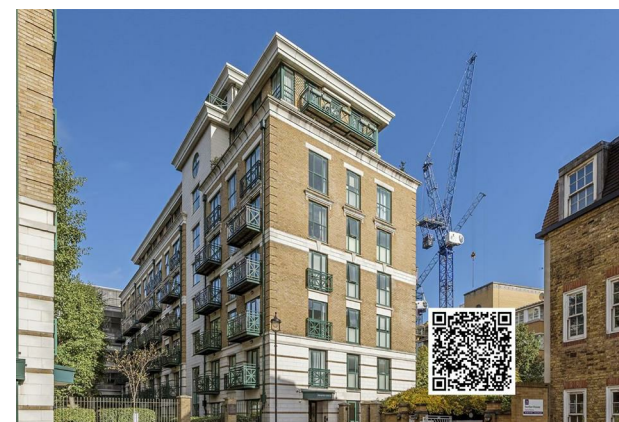

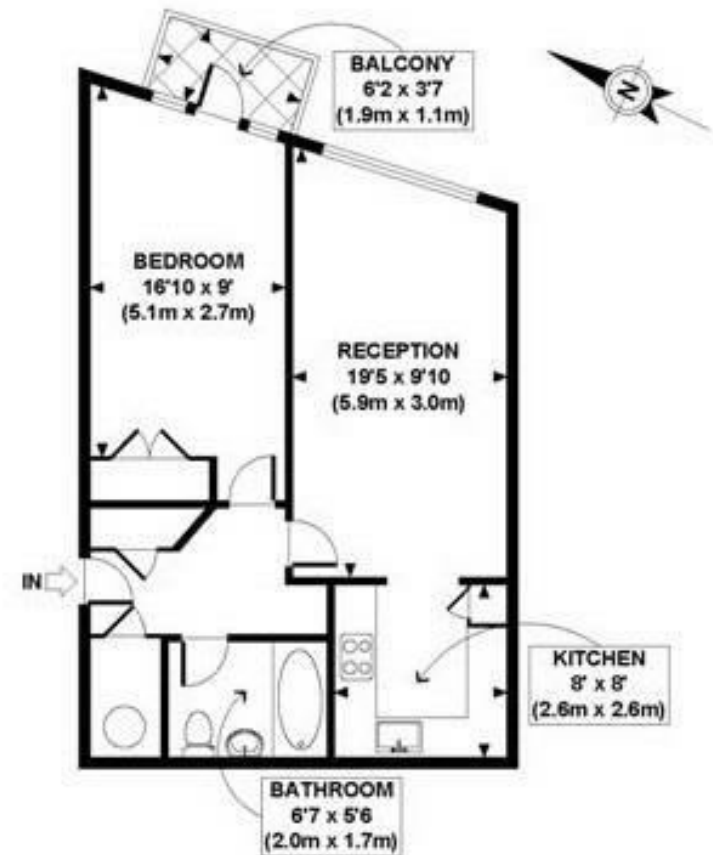

FIRST FLOOR  
GROSS INTERNAL  
FLOOR AREA 514 SQ FT

APPROX. GROSS INTERNAL FLOOR AREA 514 SQ FT / 48 SQ M  
Ref: SHGJW - Copyright [photoplan.co.uk](http://photoplan.co.uk)



